

## **THE CITY OF SPRUCE GROVE**

### **BYLAW C-1188-22**

#### **LAND USE BYLAW AMENDMENT – MCLAUGHLIN STAGE 7**

WHEREAS, pursuant to the *Municipal Government Act*, RSA 2000 cM-26, a municipality shall pass a land use bylaw and may amend the land use bylaw;

AND WHEREAS, the City of Spruce Grove wishes to amend Bylaw C-824-12, the Land Use Bylaw;

NOW THEREFORE, the Council for the City of Spruce Grove, duly assembled, hereby enacts as follows:

1. Bylaw C-824-12, Schedule A: City of Spruce Grove Land Use Districts Map, is amended as follows:
  - 1.1 To redistrict a portion of the NW 4-53-27-W4M from UR - Urban Reserve District to R1 - Mixed Low to Medium Density Residential District and P2 – Natural Areas District, as shown on the map below:

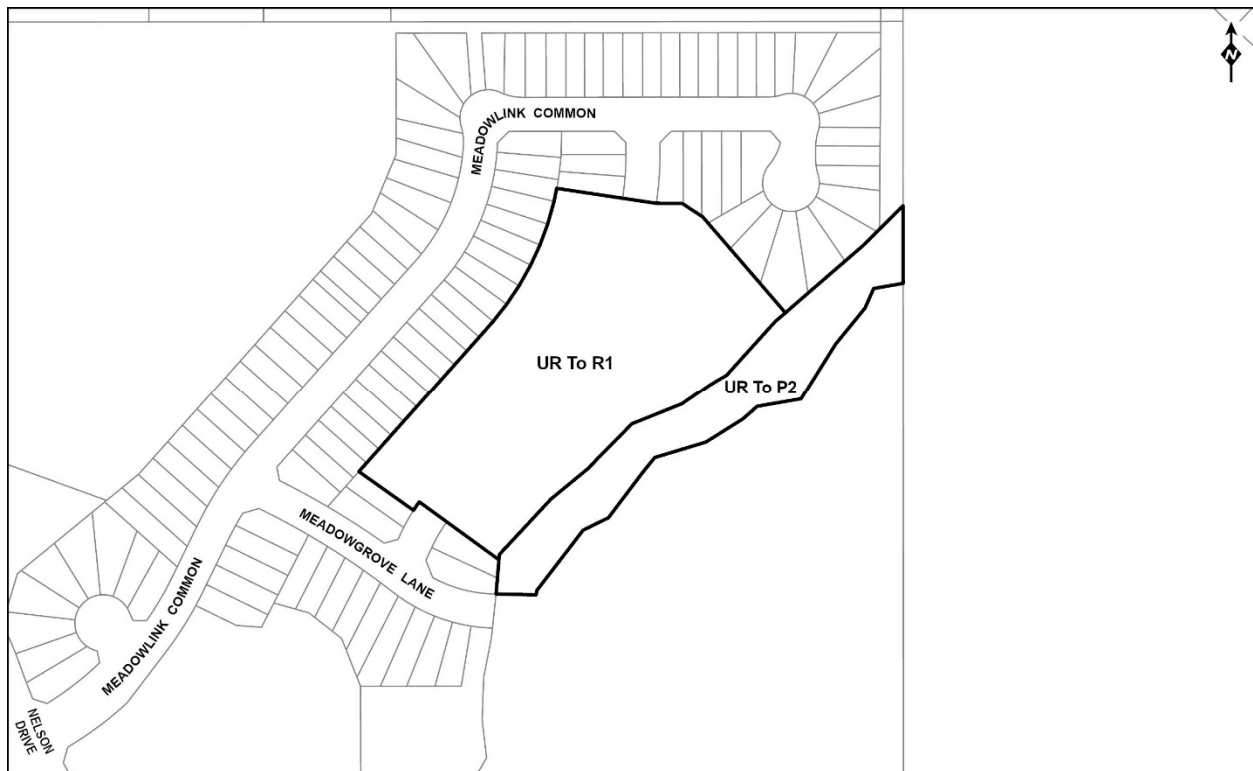

2. This amending bylaw shall be consolidated into Bylaw C-824-12.
3. This bylaw shall come into force and effect when it receives third reading and is duly signed.

First Reading Carried

Second Reading Carried

Third Reading Carried

Date Signed

---

Mayor

---

City Clerk