A large, stylized teal graphic on the left side of the page, consisting of several overlapping, curved, brushstroke-like shapes.

Bylaw C-1172-21 Ball Park District Stage 1

Second and Third Reading

A decorative element consisting of a vertical dotted teal line starting from a solid red dot, followed by a horizontal dotted teal line ending in a red double arrow pointing to the right.

City of Spruce Grove
Council Meeting
Bylaw C-1172-21
October 12, 2021

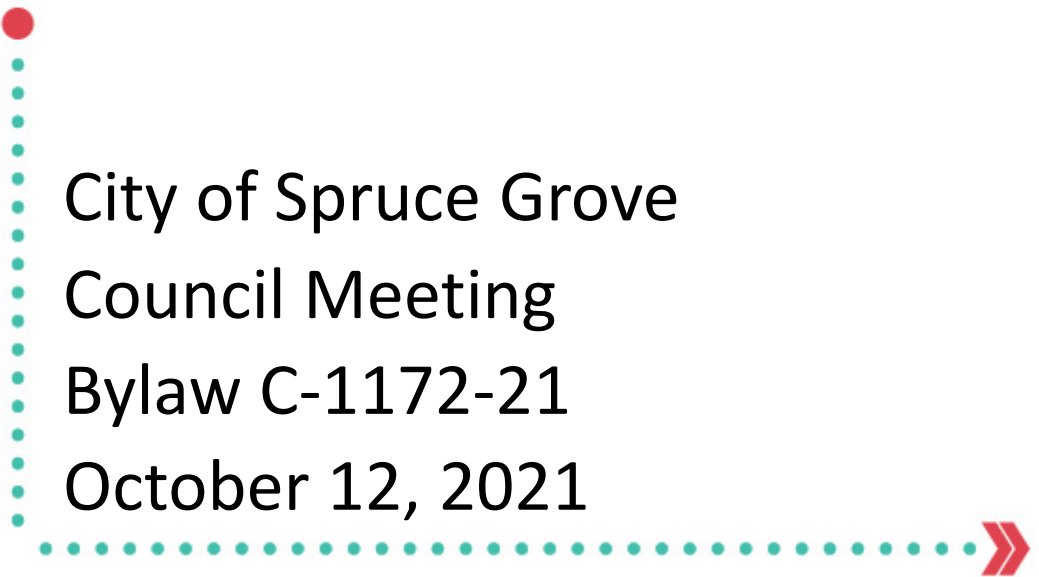

Location and Amendment



Location Aerial

Bylaw C-1172-21

Proposed Redistricting
Ball Park District Stage 1



» Legal Description:

SW 1-53-27-W4

» Redistricting:

Ball Park District Stage 1





East Pioneer ASP Compliance



ASP Overview
C-1172-21

Site of Proposed Redistricting
Ball Park District Stage 1

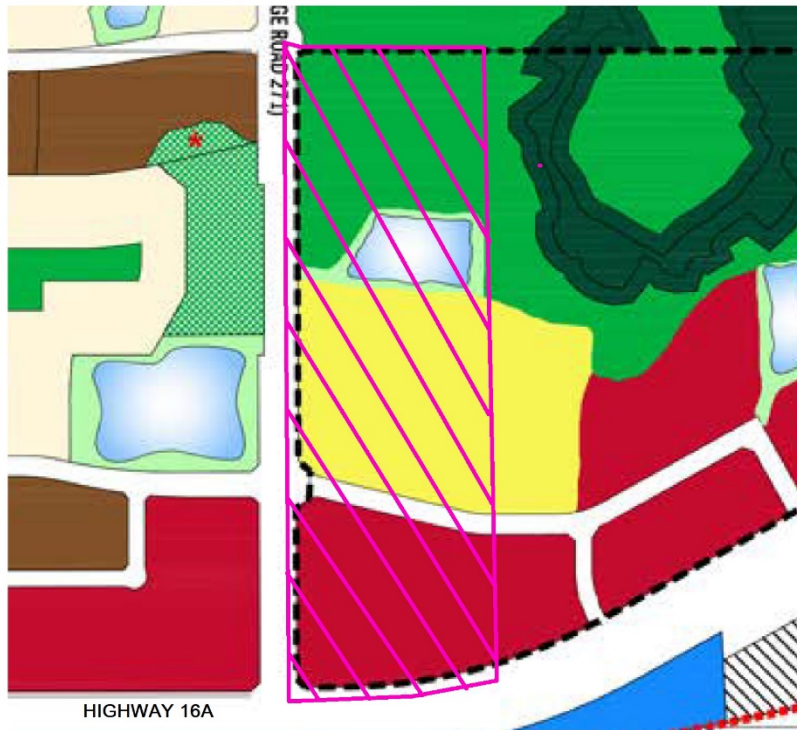

EAST PIONEER
SPRUCE GROVE
AREA STRUCTURE PLAN
LAND USE CONCEPT

LEGEND

Low to Medium Density Residential	Environmental Reserve
Medium to High Density Residential	Special Study Area
Commercial	Entertainment District
Institutional	Potential Park
Park / Open Space	Potential Private Collector
Easton Natural Area	ASP Boundary
Stormwater Management Facility	Amendment Boundary

» Land Use Concept

- » Park / Open Space
- » Stormwater Management Facility
- » Entertainment
- » Commercial

» Intended Land Use

- » Natural Area Park
- » Stormwater Management Facility
- » Stadium
- » Vehicle Oriented Commercial



Proposed Amendment

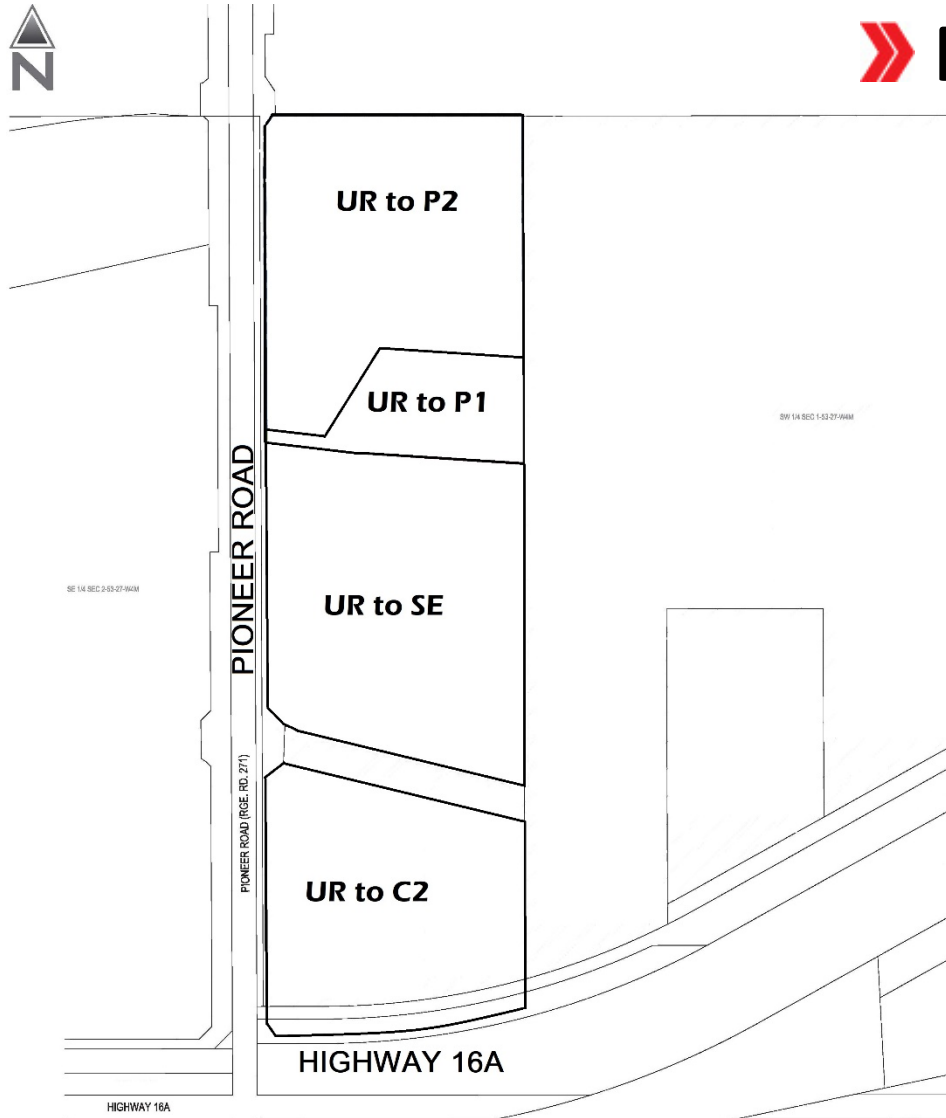

» Proposed Redistricting

» From:

- **UR**– Urban Reserve

» To:

- **P2** – Natural Areas
- **P1** – Parks and Recreation
- **SE** – Sports and Entertainment
- **C2** – Vehicle Oriented Commercial

Questions & Comments

