

THE CITY OF SPRUCE GROVE

BYLAW C-1255-23

LAND USE BYLAW AMENDMENT – EASTON STAGE 4

WHEREAS, pursuant to the *Municipal Government Act*, RSA 2000 cM-26, a municipality shall pass a land use bylaw and may amend the land use bylaw;

AND WHEREAS, the City of Spruce Grove wishes to amend Bylaw C-824-12, the Land Use Bylaw;

NOW THEREFORE, the Council for the City of Spruce Grove, duly assembled, hereby enacts as follows:

1. Bylaw C-824-12, Schedule A: City of Spruce Grove Land Use Bylaw Map, is amended as follows:
 - 1.1 To redistrict a portion of SE ¼ Section 2 Township 53 Range 27 W4M from UR – Urban Reserve District to EPL - Easton Planned Lot District and R1 – Mixed Low to Medium District and R2 – Mixed Medium to High Density District, as shown on the map below:

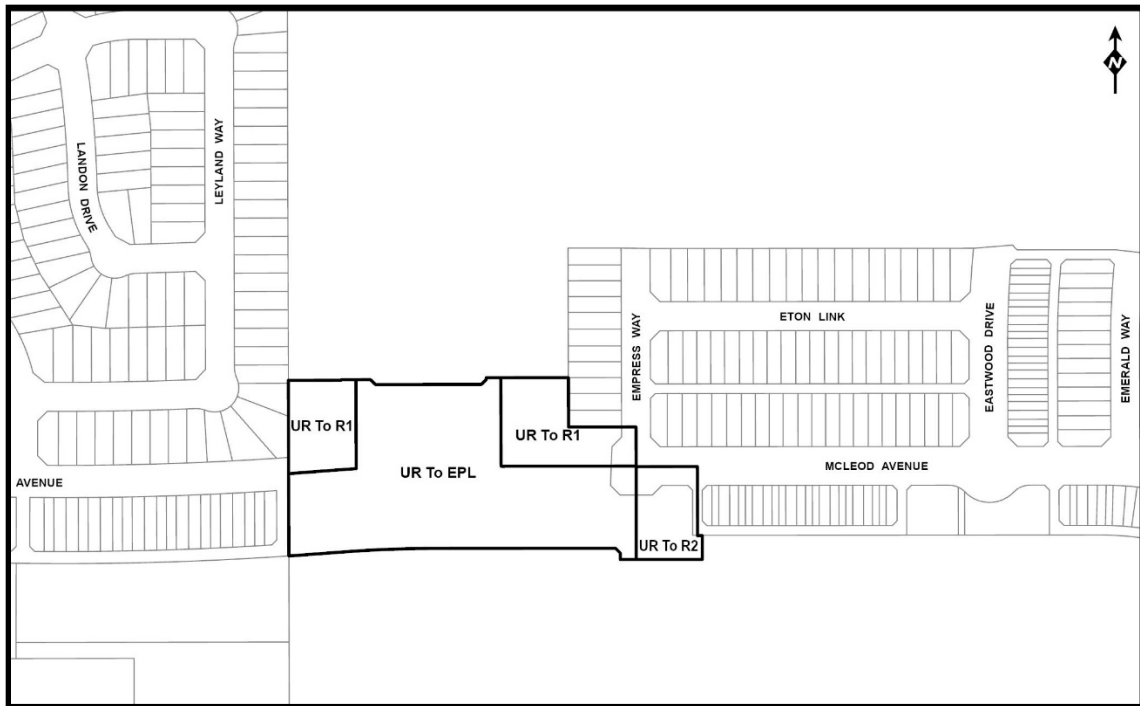

2. This amending bylaw shall be consolidated into Bylaw C-824-12.
3. This bylaw shall come into force and effect when it receives third reading and is duly signed.

First Reading Carried

Second Reading Carried

Third Reading Carried

Date Signed

Mayor

City Clerk