

THE CITY OF SPRUCE GROVE

BYLAW C-1188-22

LAND USE BYLAW AMENDMENT – MCLAUGHLIN STAGE 7

WHEREAS, pursuant to the *Municipal Government Act*, RSA 2000 cM-26, a municipality shall pass a land use bylaw and may amend the land use bylaw;

AND WHEREAS, the City of Spruce Grove wishes to amend Bylaw C-824-12, the Land Use Bylaw;

NOW THEREFORE, the Council for the City of Spruce Grove, duly assembled, hereby enacts as follows:

1. Bylaw C-824-12, Schedule A: City of Spruce Grove Land Use Districts Map, is amended as follows:
 - 1.1 To redistrict a portion of the NW 4-53-27-W4M from UR - Urban Reserve District to R1 - Mixed Low to Medium Density Residential District and P2 – Natural Areas District, as shown on the map below:

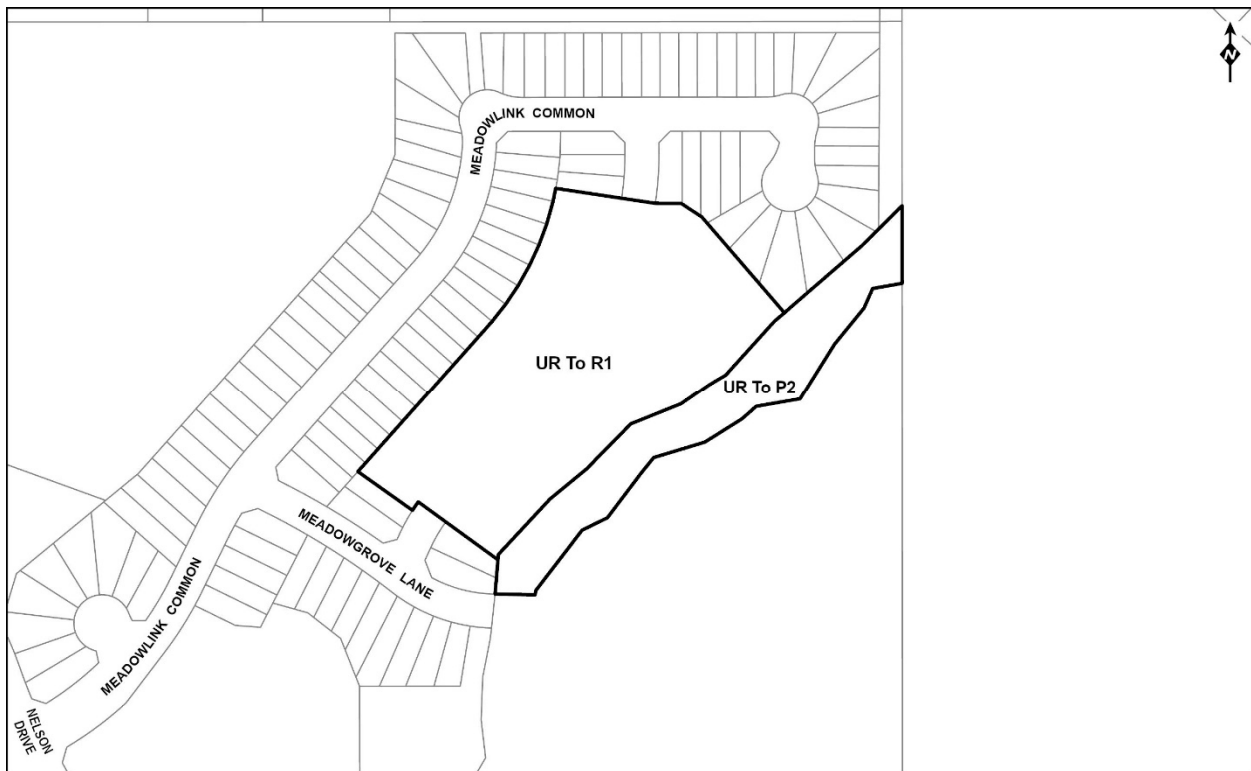

2. This amending bylaw shall be consolidated into Bylaw C-824-12.
3. This bylaw shall come into force and effect when it receives third reading and is duly signed.

First Reading Carried 28 February 2022

Second Reading Carried

Third Reading Carried

Date Signed

Mayor

City Clerk